

Mae'r Cyngor yn ymgynghori ar Lwybr Teithio Llesol arfaethedig yn seiliedig ar yr opsiynau a ddangosir. Mae rhagor o fanylion am yr ymgynghoriad hwn ar gael yn <https://www.valeofglamorgan.gov.uk/en/living/transportation/Active-Travel-and-Safe-Routes-in-Communities-Projects.aspx>

## Llwybr Teithio Llesol yr A48 i Dregolwyn

### A48 to Colwinston Active Travel Route



The Council is consulting on a proposed Active Travel Route based on the options shown. Further details about this consultation are available at <https://www.valeofglamorgan.gov.uk/cy/living/Transportation/Active-Travel-and-Safe-Routes-in-Communities-Projects.aspx>

## Description of Scheme Proposal

The Council is consulting with residents over plans to construct an Active Travel route from Colwinston to the A48. There is currently no separate provision for pedestrians or cyclists available to residents.

[Project Zero](#) is the Vale of Glamorgan Council's response to the climate change emergency. Our key target is to reduce the Council's carbon emissions to net zero by 2030 but we also want to influence and encourage others to reduce their emissions and to be part of **Project Zero**. Improvements to sustainable travel options and increasing the number of journeys made by active travel (walking and cycling) is a key part of the plan.

This is the first stage of a two-part consultation process. We are beginning with three proposed route options and need your input to decide which option we take forward to design stages, before another round of consultation on the detailed design.

The measures will deliver a safer pedestrian and cyclist environment, particularly for vulnerable road users and school pupils, and will improve accessibility into and out of the area, to bus stops on the A48 and access to public transport.

The scheme will provide a route that is safe and comfortable to use and will provide a key active travel connection to sustainable transport, schools, and community facilities. You may already be aware that a shared use facility is being constructed from Bro Castle to Bridgend, so it is our aspiration that these routes would join in the future.

The scheme option being taken forward to design, would be dependent on future grant funding.

## Disgrifiad o Gynnig y Cynllun

Mae'r Cyngor yn ymgynghori â thrigolion ynghylch cynlluniau i adeiladu llwybr Teithio Llesol o Dregolwyn i'r A48. Ar hyn o bryd nid oes darpariaeth ar wahân ar gael i drigolion sydd am gerdded neu feicio.

**Prosiect Sero** yw ymateb Cyngor Bro Morgannwg i'r argyfwng newid hinsawdd. Ein prif darged yw lleihau allyriadau carbon y Cyngor i sero net erbyn 2030 ond rydym hefyd am ddylanwadu ar ac annog eraill i leihau eu hallyriadau a bod yn rhan o **Prosiect Sero**. Mae gwella opsiynau teithio cynaliadwy a chynyddu nifer y teithiau a wneir trwy deithio llesol (cerdded a beicio) yn rhan allweddol o'r cynllun hwn.

Dyma gam cyntaf proses ymgynghori dwy ran. Rydym yn dechrau gyda thri llwybr posibl ac mae angen eich mewnbwn chi arnom i benderfynu pa opsiwn y byddwn yn bwrw ymlaen ag ef i'r camau dylunio, cyn rownd arall o ymgynghori ar y dyluniad manwl.

Bydd y mesurau'n sicrhau amgylchedd mwy diogel i gerddwyr a beicwyr, yn enwedig ar gyfer defnyddwyr ffordd agored i niwed a disgyblion ysgol, a bydd yn gwella hygyrchedd i mewn ac allan o'r ardal, i arosfannau bws ar yr A48 a mynediad at drafnidiaeth gyhoeddus.

Bydd y cynllun yn darparu llwybr sy'n ddiogel a chyfforddus i'w ddefnyddio ynghyd â chysylltiad teithio llesol allweddol i drafnidiaeth gynaliadwy, ysgolion, a chyfleusterau cymunedol. Efallai eich

bod eisoes yn ymwybodol bod cyfleuster defnydd a rennir yn cael ei adeiladu o Frocastell i Ben-y-bont ar Ogwr, felly ein dyhead yw i'r llwybrau hyn uno yn y dyfodol.

Rydym wedi gwneud cais am grant Teithio Llesol Llywodraeth Cymru i ariannu'r cynllun hwn.

## Route option A / Opsiwn llwybr A

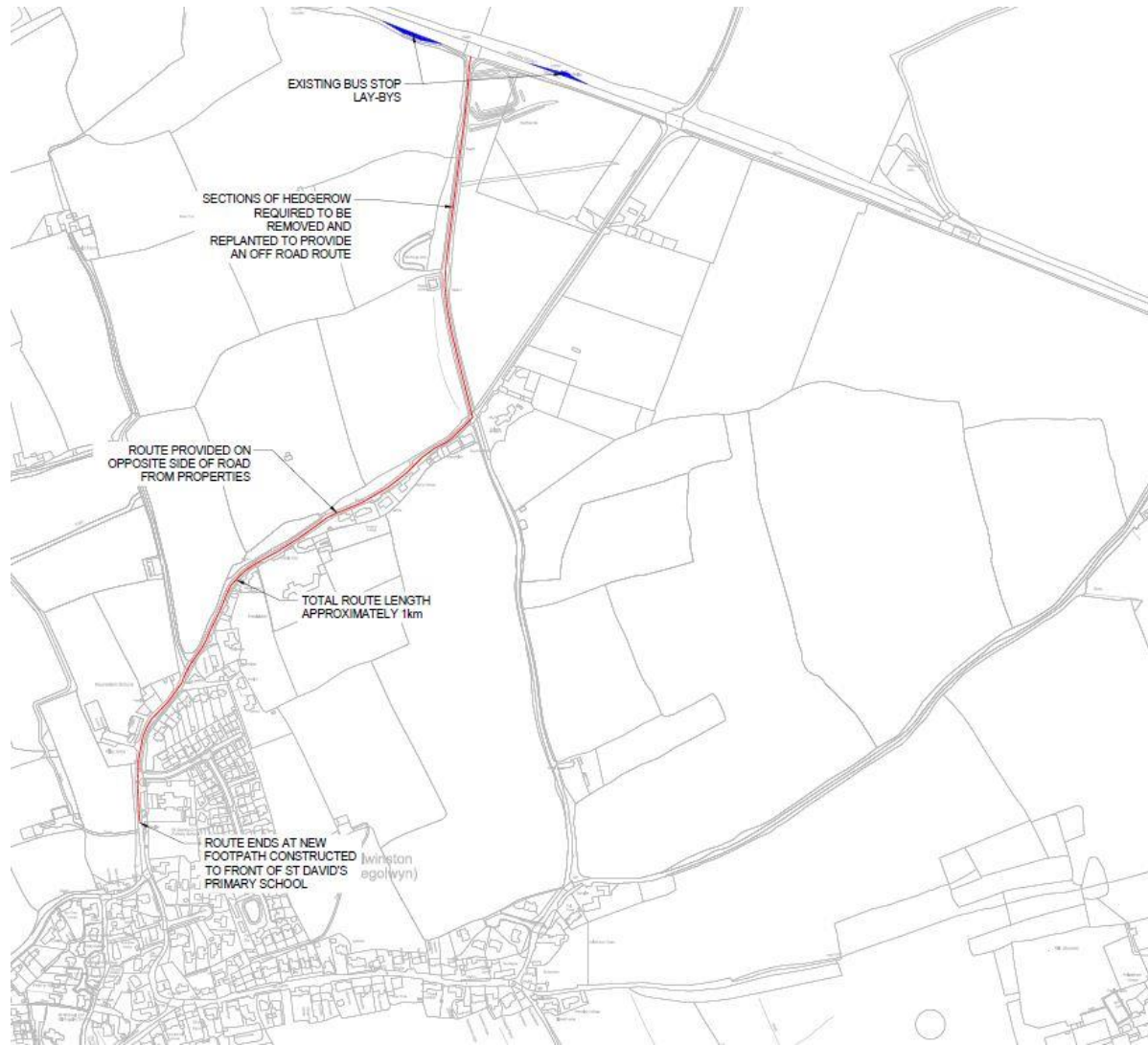

## Route option B / Opsiwn llwybr B

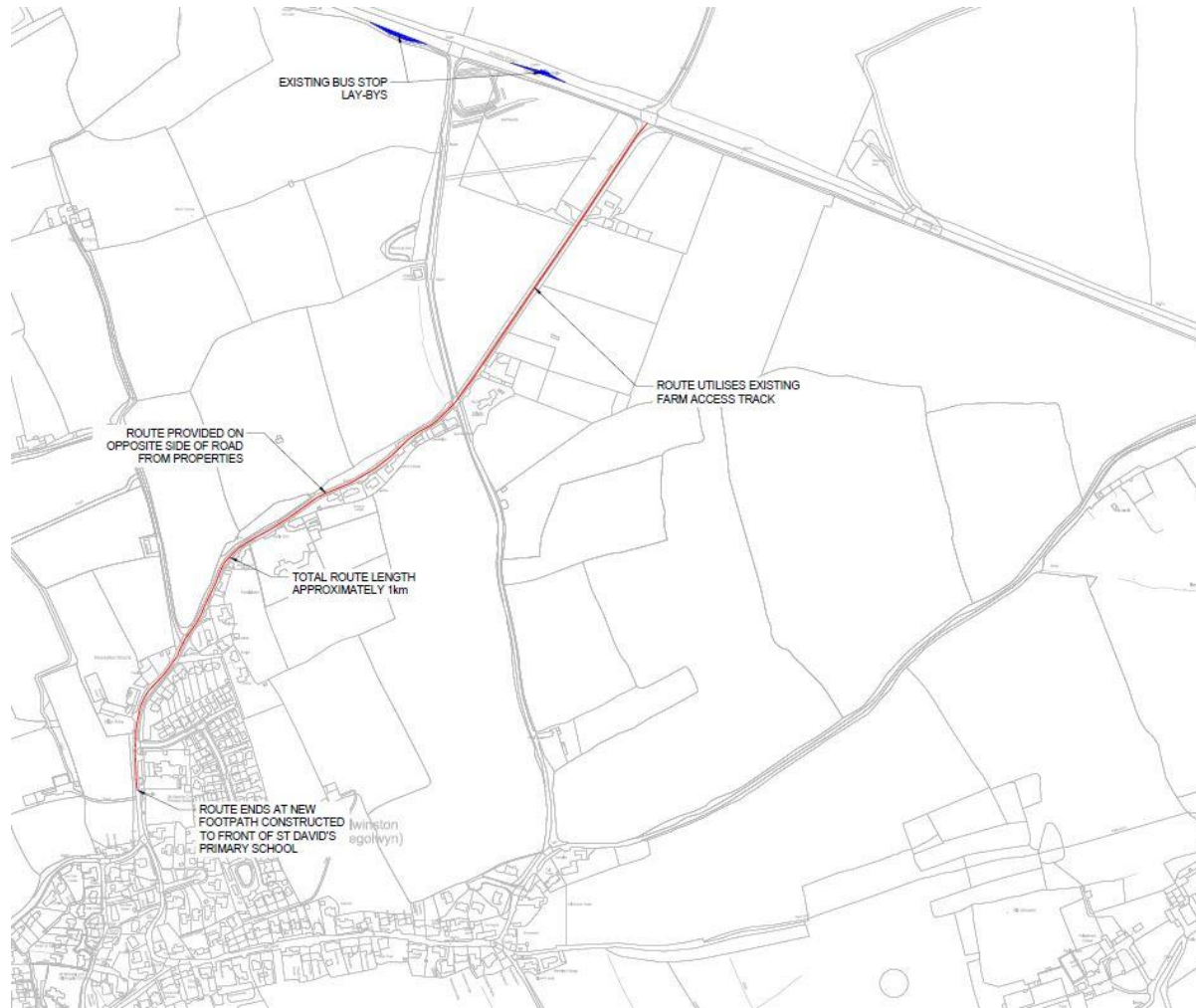

### Route option C / Opsiwn llwybr C

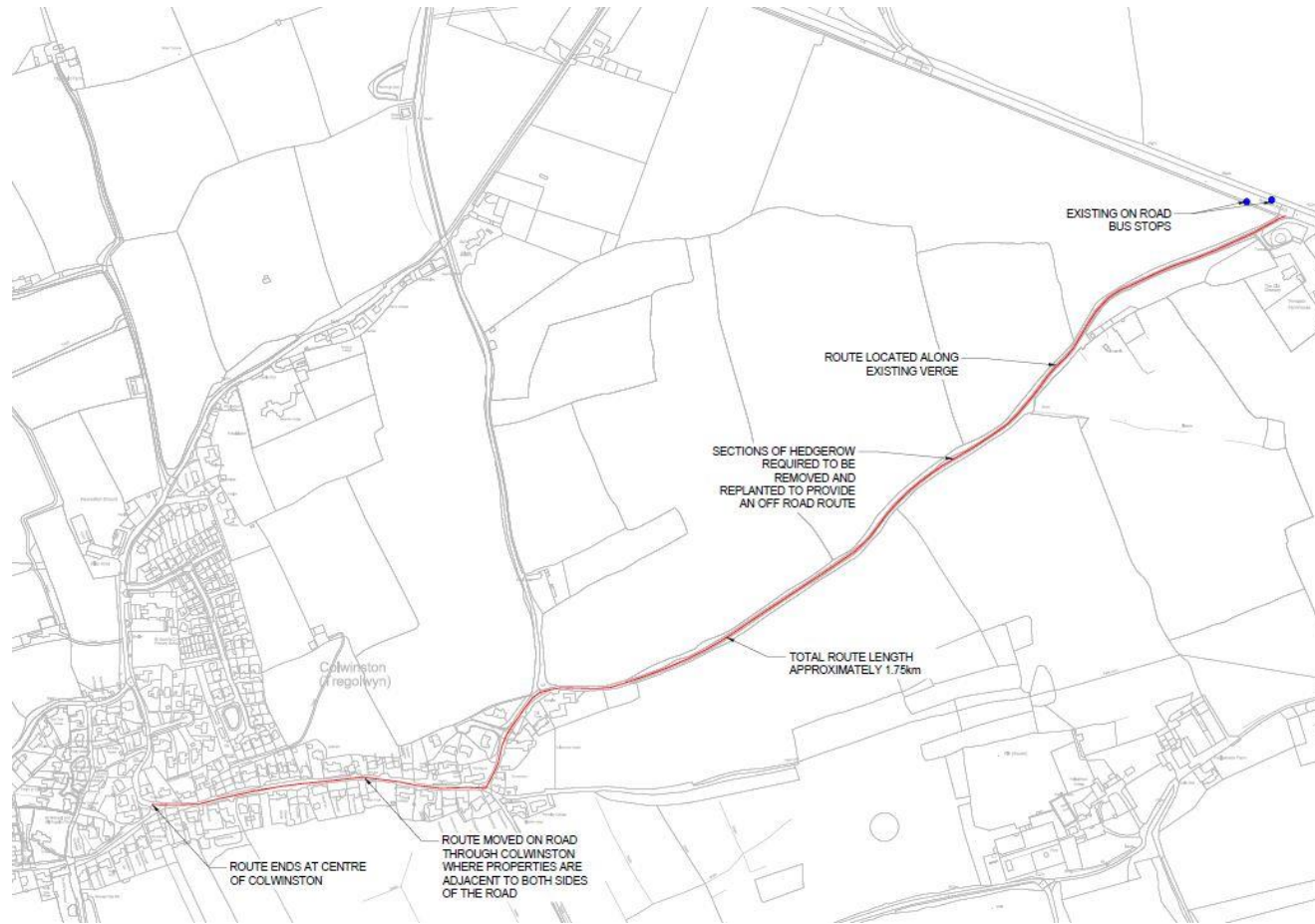

## Evaluation of the three route options

The table below provides a summary of the route options and comparison against the key criteria of the project and is scored in relation to a potential future route in each instance.



The scores in the matrix below are not factored, for example, pedestrian & cyclist safety is scored as equally as important as the route length which may not actually be the case, therefore this scoring matrix is provided as a guide only.

### Gwerthusiad o'r tri opsiwn llwybr

Mae'r tabl isod yn rhoi crynodeb o'r opsiynau llwybr a chymhariaeth yn erbyn meini prawf allweddol y prosiect a chaiff ei sgorio mewn perthynas â llwybr posibl yn y dyfodol ym mhob achos.

Nid yw'r sgorau yn y matrices isod wedi'u ffactorio, er enghraifft, mae diogelwch cerddwyr a beicwyr yn cael ei sgorio yr un mor bwysig â hyd y llwybr ac efallai nad yw'n wir, felly mae'r matrices sgorio hwn yn cael ei ddarparu fel canllaw yn unig.

Active Travel Route Comparison / Cymhariaeth Llwybr Teithio Llesol	Route option A / Opsiwn llwybr A	Route option B / Opsiwn llwybr B	Route option C / Opsiwn llwybr C
Pedestrian & cyclist safety / Diogelwch cerddwyr a beicwyr	5	2	2
Compliance with Active Travel Wales Guidance / Cydymffurfio â Chanllawiau Teithio Llesol Cymru	5	4	3
Route Length / Hyd y Llwybr	0.75miles (4)	0.7miles (5)	1 mile (3)
Engineering constraints / Cyfyngiadau peirianeg	5	5	4
Landscape & visual impact / Tirwedd ac effaith weledol	3	5	4
Ecological impact / Effaith ecolegol	3	4	3
Proximity to bus stops / Agosrwydd at arosfannau bysiau	5	3	5
<b>Total / Cyfanswm</b>	<b>30</b>	<b>28</b>	<b>24</b>

	High / Adverse Risk	Risg Uchel / Andwyol
	Medium / Neutral Risk	Risg Canolig / Niwtral
	Low / Favourable Risk	Risg Isel / Ffariol

### **Next steps:**

Once a preferred route option has been decided there are several things that need to be done to proceed:

#### *Land ownership considerations:*

The preferred route may require removal/replanting of existing hedgerow and/or trees. Discussions with relevant landowners must take place at the earliest opportunity.

#### *Engineering considerations:*

Topographical survey information is not currently available for the proposed routes. These need to be completed.

#### *Ecological considerations:*

Any route in this area is expected to impact on hedgerows and trees. An ecological survey must be undertaken to determine whether any protected species may be impacted by the provision of any new active travel infrastructure.

### **Camau nesaf:**

Unwaith y bydd dewis llwybr a ffefrir wedi'i benderfynu, mae nifer o bethau y mae angen eu gwneud i symud ymlaen:

#### *Ystyriaethau perchnogaeth tir:*

Mae'n bosibl y bydd y llwybr a ffefrir angen tynnu/ailblannu gwrychoedd a/neu goed presennol. Rhaid cynnal trafodaethau gyda thirfeddianwyr perthnasol cyn gynted â phosibl.

#### *Ystyriaethau peirianeg:*

Nid oes gwybodaeth arolwg topograffig ar gael ar hyn o bryd ar gyfer y llwybrau arfaethedig. Mae angen cwblhau'r rhain.

#### *Ystyriaethau ecolegol:*

Disgwylir i unrhyw lwybr yn yr ardal hon effeithio ar wrychoedd a choed. Rhaid cynnal arolwg ecolegol i benderfynu a allai unrhyw rywogaethau a warchodir gael eu heffeithio gan ddarpariaeth unrhyw seilwaith teithio llesol newydd.

### **How to respond**

To register your preference of options and provide feedback, please follow this link to our survey: <https://forms.office.com/r/grVuvwFcG5>

Responses must be submitted by 23 March 2022.

If you would like to make any comments about this proposal please let us know by 23 March 2022 by email to [ActiveTravel@valeofglamorgan.gov.uk](mailto:ActiveTravel@valeofglamorgan.gov.uk) or write to Active Travel, Vale of Glamorgan Council, The Alps Depot, Quarry Road, Wenvoe

If you wish to discuss the proposals over the phone, please call 01446 700111 and request a call back.



## **Sut i ymateb**

I gofrestru'r opsiynau a ffefrir gennych ac i roi adborth, dilynwch y ddolen hon i'n harolwg:  
<https://forms.office.com/r/grVuvwFcG5>

Rhaid cyflwyno ymatebion erbyn 23 Mawrth 2022.

Os hoffech wneud unrhyw sylwadau am y cynnig hwn rhowch wybod i ni erbyn 23 Mawrth 2022 drwy e-bost i [ActiveTravel@valeofglamorgan.gov.uk](mailto:ActiveTravel@valeofglamorgan.gov.uk) neu drwy ysgrifennu at Teithio Llesol, Cyngor Bro Morgannwg, Depo'r Alpau, Heol y Chwarel, Gwenfô

Os hoffech drafod y cynnigion dros y ffôn, ffoniwch 01446 700111 a gofyn am alwad yn ôl.