

Mae'r Cyngor yn ymgynghori ar Lwybr Teithio Llesol arfaethedig yn seiliedig ar y cynllun a ddangosir. Mae rhagor o fanylion am yr ymgynghoriad hwn ar gael yn <https://www.valeofglamorgan.gov.uk/cy/living/Transportation/Active-Travel-and-Safe-Routes-in-Communities-Projects.aspx>

# Llwybr Teithio Llesol Heol Caerdydd

## Cardiff Road Active Travel Route



The Council is consulting on a proposed Active Travel Route based on the plan shown. Further details about this consultation are available at <https://www.valeofglamorgan.gov.uk/en/living/transportation/Active-Travel-and-Safe-Routes-in-Communities-Projects.aspx>

## Description of Scheme Proposal

The Council is consulting with residents over plans to improve the existing active travel route along Cardiff Road to provide a better-quality walking, cycling and wheeling experience for all users. The proposed route will provide this by increasing the width of the existing pathway, providing segregated facilities wherever possible.

Through recent active travel consultations, concerns have been raised about the highway environment in this area. In response, officers from the Council have investigated options to make improvements which will create a safer walking, cycling and wheeling environment.

The main road safety issues identified were related to vehicle speeds and the cycle and pedestrian facilities. To combat these issues, we are proposing the following as part of the active travel improvements:

- Segregated cycle and pedestrian paths along Cardiff Road where possible;
- Carriageway narrowing to a minimum of 6.1m in line with current design guidance;
- Pedestrian crossing improvements and junction narrowing to provide safer crossing for vulnerable road users;
- Signalised crossing on Sully Moors Road;
- Removal of priority right hand turns into industrial estates;
- Additional seating and planting along the route to make it a more pleasant environment.

The measures will deliver a safer pedestrian and cyclist environment, particularly for vulnerable road users and school pupils, and will improve accessibility to schools, the town centre and onward travel to Barry Island, Penarth and onto Cardiff.

**Project Zero** is the Vale of Glamorgan Council's response to the climate change emergency. Our key target is to reduce the Council's carbon emissions to net zero by 2030 but we also want to influence and encourage others to reduce their emissions and to be part of **Project Zero**. Improvements to sustainable travel options and increasing the number of journeys made by active travel (walking and cycling) is a key part of the plan.

This scheme is being funded through the Welsh Government Active Travel grant. Details of current active travel schemes can be found by following this link:

<https://www.valeofglamorgan.gov.uk/en/living/transportation/Active-Travel-and-Safe-Routes-in-Communities-Projects.aspx>

We would appreciate any comments you may have regarding the proposals. We understand you may have suggestions for other improvements to increase safety within this area. Due to funding constraints we may be unable to accommodate any significant changes to these plans at this time, however we will keep a record of any suggestions we receive to incorporate into future schemes.

## Disgrifiad o Gynnig y Cynllun

Mae'r Cyngor yn ymgynghori â phreswylwyr ynghylch cynlluniau i wella'r llwybr teithio llesol presennol ar hyd Heol Caerdydd i gynnig profiad cerdded, beicio ac olwynio o ansawdd gwell i bob defnyddiwr. Bydd y llwybr arfaethedig yn sicrhau hyn drwy gynyddu lled y llwybr presennol, gan gynnig cyfleusterau ar wahân lle bynnag y bo modd.

Drwy ymgynghoriadau teithio llesol diweddar, mynegwyd pryderon am amgylchedd y briffordd yn yr ardal hon. Mewn ymateb i hyn, mae swyddogion y Cyngor wedi ymchwilio i ffyrdd o wneud gwelliannau a fydd yn helpu i greu amgylchedd cerdded, beicio ac olwynio diogelach.

Y prif broblemau a nodwyd o ran diogelwch ar y ffordd oedd cyflymder cerbydau a diffyg cyfleusterau i gerddwyr a beicwyr. Er mwyn mynd i'r afael â'r problemau hyn, rydym yn cynnig y canlynol yn rhan o'r gwelliannau teithio llesol:

- Llwybrau beicio a cherdded ar wahân ar hyd Heol Caerdydd lle bo hynny'n bosibl;
- Culhau'r lôn gerbydau i 6.1m o leiaf yn unol â'r canllawiau dylunio cyfredol;
- Gwella croesfannau i gerddwyr a chulhau cyffyrdd i sicrhau croesfannau mwy diogel i ddefnyddwyr y ffordd sy'n agored i niwed;
- Croesfan â signalau ar Sully Moors Road;
- Dileu'r mesur sy'n rhoi blaenoriaeth i gerbydau wrth iddynt droi i'r dde i ystadau diwydiannol;
- Seddi a phlanhigion ychwanegol ar hyd y llwybrau i greu amgylchedd mwy dymunol.

Bydd y mesurau'n creu amgylchedd mwy diogel i gerddwyr a beicwyr, yn benodol i ddefnyddwyr y ffordd sy'n agored i niwed a disgyblion ysgol, a byddant yn gwella mynediad i ysgolion, i ganol y dref ac i Ynys y Barri, Penarth a Chaerdydd.

**Prosiect Sero** yw ymateb Cyngor Bro Morgannwg i argyfwng y newid yn yr hinsawdd. Ein prif darged yw lleihau allyriadau carbon y Cyngor i sero net erbyn 2030 ond rydym hefyd am ddylanwadu ar eraill a'u hannog i leihau eu hallyriadau a bod yn rhan o **Brosiect Sero**. Mae gwella opsiynau teithio cynaliadwy a chynyddu nifer y teithiau a wneir trwy deithio llesol (cerdded a beicio) yn rhan allweddol o'r cynllun hwn.



Grant Teithio Llesol Llywodraeth Cymru sy'n ariannu'r cynllun hwn. Ceir manylion y cynlluniau teithio llesol cyfredol trwy ddilyn y ddolen hon:

<https://www.valeofglamorgan.gov.uk/cy/living/Transportation/Active-Travel-and-Safe-Routes-in-Communities-Projects.aspx>

Byddem yn gwerthfawrogi unrhyw sylwadau sydd gennych ynghylch y cynigion. Rydym yn deall y gallai fod gennych awgrymiadau eraill i wella diogelwch yn yr ardal hon. O ganlyniad i gyfyngiadau ariannol efallai na fydd modd i ni newid y cynlluniau hyn yn sylweddol ar hyn o bryd, ond byddwn yn cadw cofnod o unrhyw awgrymiadau a ddaw i law er mwyn eu cynnwys mewn cynlluniau yn y dyfodol.

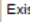
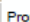
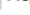

# CARDIFF ROAD, BARRY, PROPOSED ACTIVE TRAVEL IMPROVEMENT

Key	
	Existing carriageway
	Pedestrian crossing facilities
	Areas of landscape to remain
	Proposed footway/cycleway improvements
	Areas of landscape to be improved
	New Areas of landscape

Carriageway width to be reduced to 6.1m to construct shared footway/cycleway and to aid in speed reduction

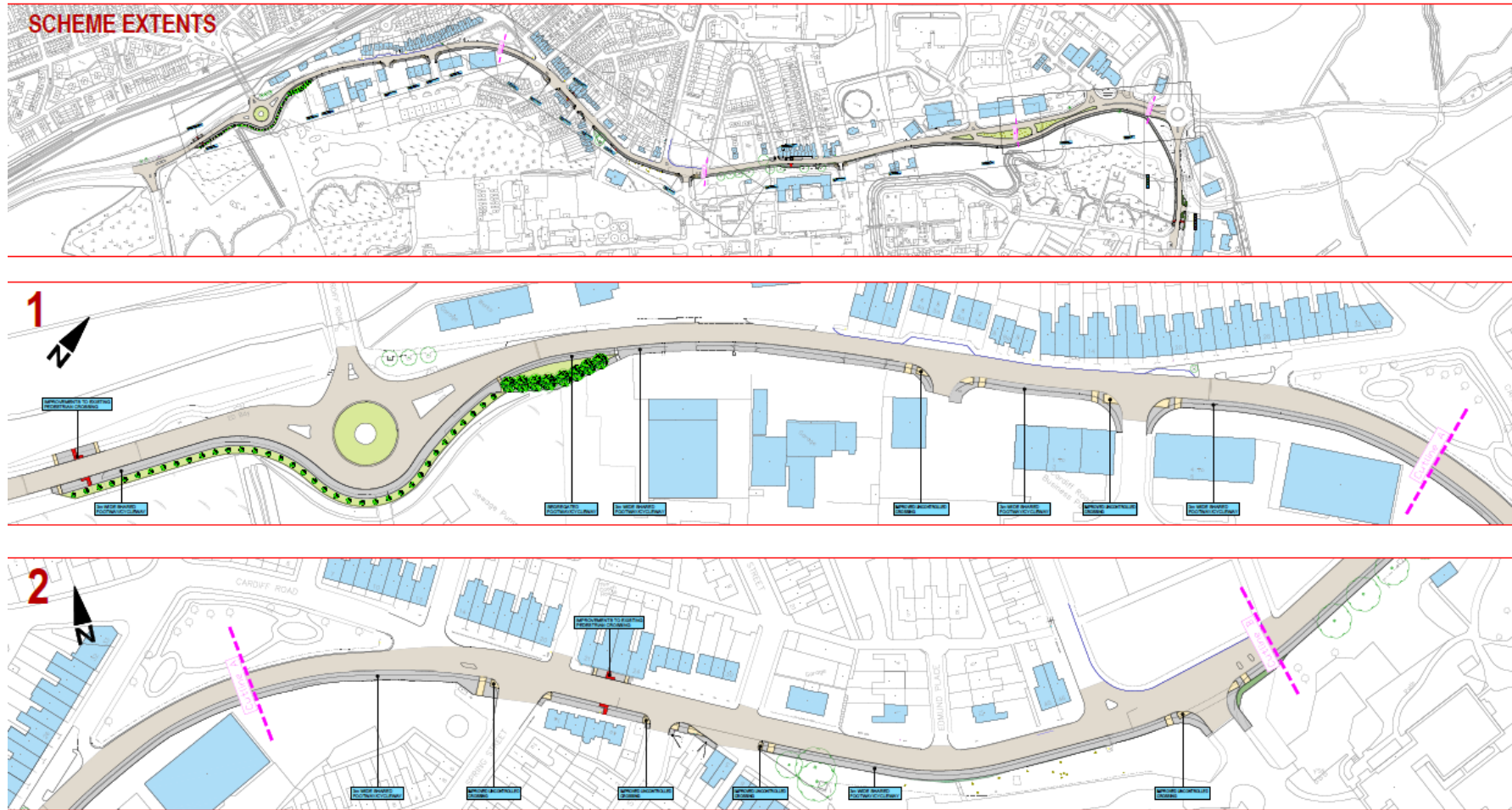



# CARDIFF ROAD, BARRY, PROPOSED ACTIVE TRAVEL IMPROVEMENT

Key					
	Existing carriageway		Pedestrian crossing facilities		Areas of landscape to remain
	Proposed footway/cycleway improvements		Areas of landscape to be improved		New Areas of landscape

Carriageway width to be reduced to 6.1m to construct shared footway/cycleway and to aid in speed reduction

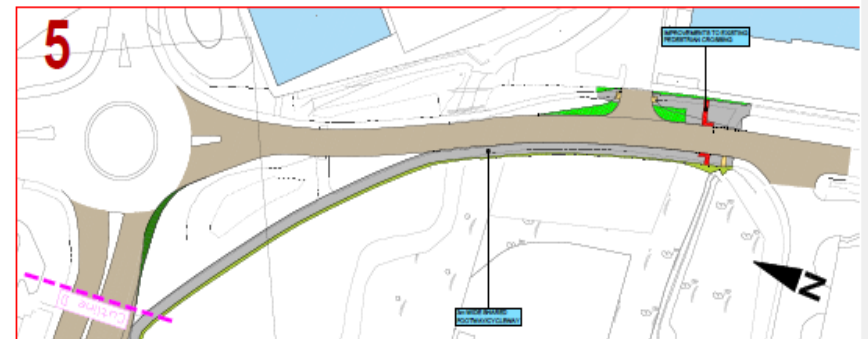

## How to respond

An online survey is available here for you to respond to the proposals:

<https://www.valeofglamorgan.gov.uk/en/living/transportation/Active-Travel-and-Safe-Routes-in-Communities-Projects.aspx>

or by scanning this QR code:



Responses must be submitted by 12 October 2021.

If you would like to make any comments about this proposal please let us know by 12 October 2021 by email to [ActiveTravel@valeofglamorgan.gov.uk](mailto:ActiveTravel@valeofglamorgan.gov.uk) or write to Active Travel, Vale of Glamorgan Council, The Alps Depot, Quarry Road, Wenvoe

## Sut i ymateb

Mae arolwg ar-lein ar gael yma i chi ymateb i'r cynigion:

<https://www.valeofglamorgan.gov.uk/cy/living/Transportation/Active-Travel-and-Safe-Routes-in-Communities-Projects.aspx>

neu drwy sganio'r cod QR hwn:



Rhaid cyflwyno ymatebion erbyn 12 Hydref 2021.

Os hoffech chi wneud unrhyw sylwadau am y cynnig hwn, rhowch wybod i ni erbyn 12 Hydref 2021 drwy e-bost i [ActiveTravel@valeofglamorgan.gov.uk](mailto:ActiveTravel@valeofglamorgan.gov.uk) neu drwy ysgrifennu at Teithio Llesol, Cyngor Bro Morgannwg, Depo'r Alpau, Heol y Chwarel, Gwenfô